



# Milford Shopping Center

859-331-1560  
**TOEBBEN**  
COMPANIES  
[www.toebben.com](http://www.toebben.com)

**Go where the money is.** Looking for a money-making place for your business? Consider Milford Shopping Center! Located in the growing Milford area, this totally renovated community center features solid anchors like **Mazel's** and **Buck\$** discount retailers and a **Save-A-Lot** food store. Consumers from the nearby Old Milford Historic District and The Park 50 TechneCenter also frequent businesses like **Subway**, **Radio Shack**, and **Busken Bakery** -- just to name a few. With several points of access from I-275, Milford Shopping Center is a place sure to keep your cash registers humming!



# Milford Shopping Center

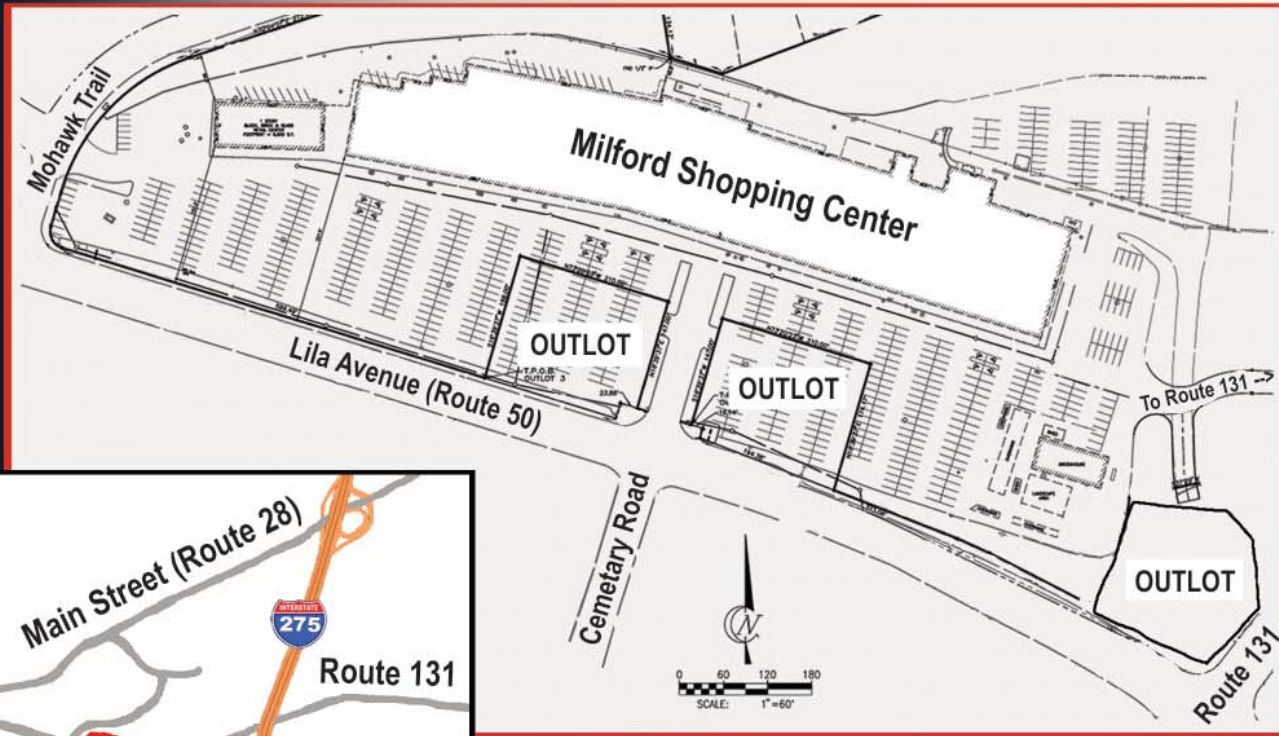

## Address:

Milford Shopping Center  
Lila Avenue near I-275  
Milford, OH

## Gross Leasable Area:

152,646 square feet

## Anchors & Amenities:

Mazel's (20,000 square feet)  
Save-A-Lot (20,000 square feet)  
Buck\$ (14,000 square feet)  
Abundant, on-site parking  
Quick access to I-275



## Directions:

Located in the city of Milford, the Milford Shopping Center can be reached from several directions. From the north take the I-275 Route 28 exit to Lila Avenue (Route 50). From the south both the Milford Parkway exit off of I-275 and Route 50 lead to the center.

## Demographics (3 Mile):

Population ..... 27,000+  
Average Household Income ..... \$88,000+  
Route 50 & Cemetary Road .... 18,750 VPD  
Route 50 & Route 131 ..... 12,510 VPD

## Contact:

Larry Rytel  
Vice President of Leasing  
Toebben Companies  
541 Buttermilk Pike, Suite 104  
Crescent Springs, KY  
859-331-1560, ext 35