



# North Bend Square

## Retail Center

### Trade Area

Located on State Route 237 in Hebron, Kentucky, less than one mile from I-275, North Bend Square Retail Center is anchored by a 50,000 square foot Remke Grocery store. Leasable area is 22,000 square feet which can be divided to meet your exact business needs.

*Space available!*



859-331-1560

**TOEBBEN**

COMPANIES

[www.toebben.com](http://www.toebben.com)

### 1 Mile Demographics

Average Household Income ..... \$117,410  
 Percent of homeowners vs renters.....92%

### 3 Mile Demographics

Average Household Income ..... \$91,947  
 Daytime Population .....13,075  
 Proposed Number of New Homes...5,757+

# North Bend Square

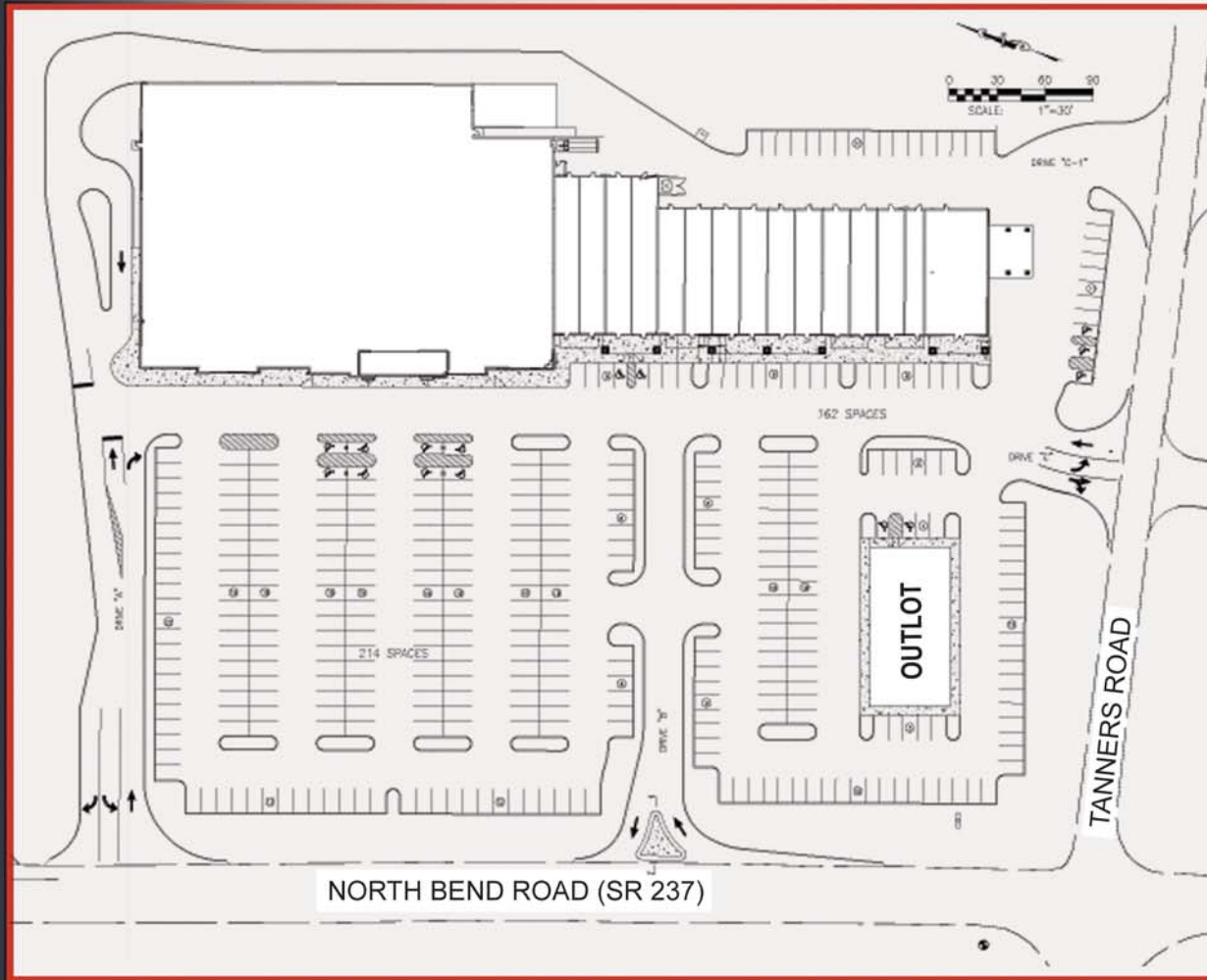

## Address:

North Bend Square  
Corner of Tanners & North Bend Rd  
Hebron, KY 41048

## Leasable Area:

Minimum 1,315 square feet

## Typical Bay Size:

2,720 square feet (34' x 80'),  
divisible into smaller spaces

## Amenities:

New center built in 2005  
Anchor is Remke Grocery  
Abundant on-site parking  
Close to airport & I-275



## Directions:

From I-75/71 take I-275 west to Hebron. After passing the airport, exit on State Route 237 (North Bend Road) and head north. Go less than one mile. The North Bend Square Shopping Center is on the NE corner of the intersection of North Bend Road and Tanners Road.



## Contact:

Larry Rytel  
Vice President of Leasing  
Toebben Companies  
541 Buttermilk Pike, Suite 104  
Crescent Springs, KY  
859-331-1560, extension 19  
lrytel@toebben.com